

1591LF Enclosure

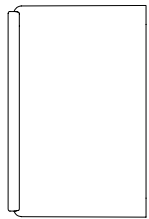

SIDE VIEW OF BOX

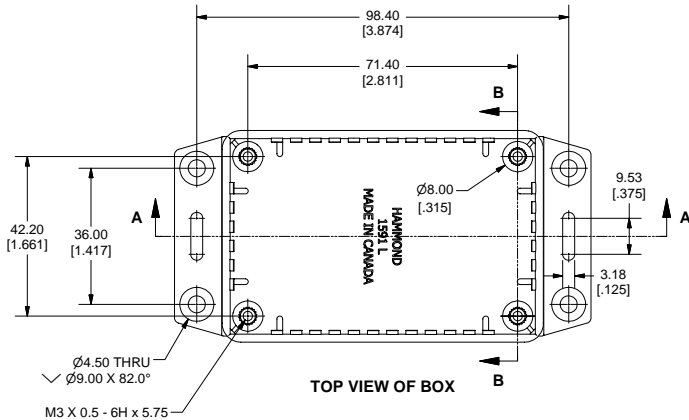

TOP VIEW OF BOX

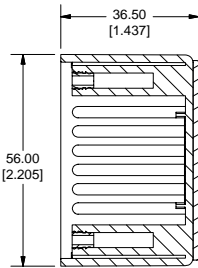

SECTION B-B

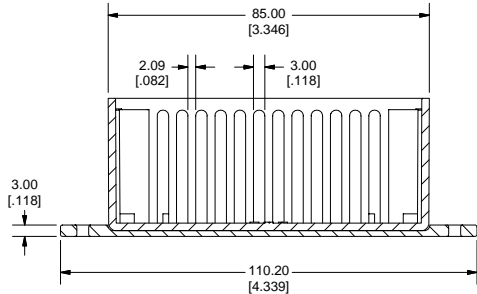

SECTION A-A

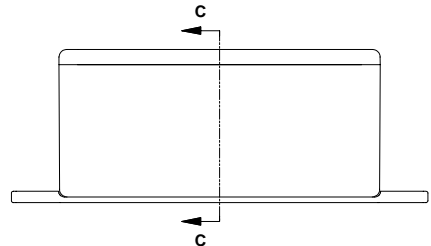

SIDE VIEW OF ASSEMBLY

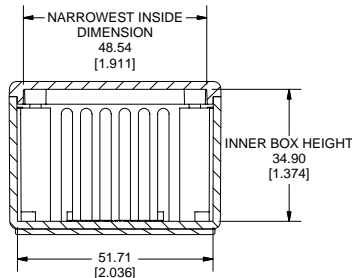

SECTION C-C

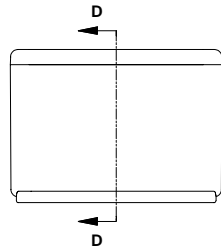

END VIEW OF ASSEMBLY

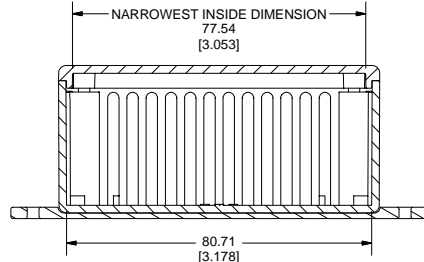

SECTION D-D

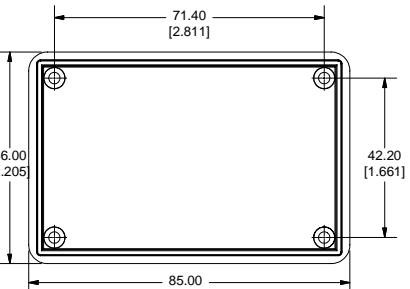

BOTTOM VIEW OF LID

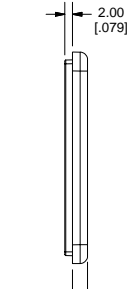

SIDE VIEW OF LID

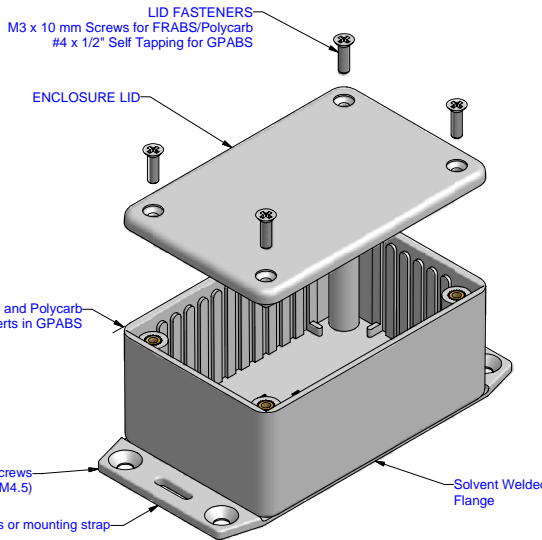

EXPLODED VIEW OF ENCLOSURE

Note:
Enclosures can be Factory Modified (Milling, Drilling, Printing etc.)
Solid models of this enclosure available in STEP or IGES Format.
Contact Factory mjm@hammondmfg.com



PART NUMBERS		
1591L Flanged Box Enclosures		
Material	Colour	Part Number
FR ABS	Black	1591LF2BK
UL94 - V0	Grey	1591LF2GY
GP ABS	Black	1591LF2SBK
	Grey	1591LF2SGY
Accessories		
Description	Part Number	
PC Board Card Adapters	See Accessories Section	
Clear Lids - clear, flame retardant polycarbonate - Lid ONLY	1591LC	
FR ABS Replacement Screws, Flat Head Phillips Nickel Plated Pkg of 100	1591MS100	
GP ABS Self Tapping Pkg of 100	1591TS100	
	1591TS100BK (Black)	
Recommended Torque on Fasteners (no lubrication)		
M3 - 0.5 x 10mm Screws	30-40 cN'm	
#4 x 0.5 Screws	30-40 cN'm	